

Balmoral

An attractive semi-detached 3 storey home offering three bedrooms, excellent living space and detached single garage - built and designed by Lindum Homes.



The image right depicts our Balmoral house type; however, please note that there may be some elevation variations so this is for guidance only.

For further information about availability and plot specific details please discuss with our Sales Team.

The downstairs living space is divided into lounge, open plan kitchen diner, along with a cloak room and entrance hall. The lounge has patio doors leading onto the garden patio area.

The first floor has two bedrooms and a study the main bathroom includes a shower bath. The second floor offers a master bedroom with en-suite and useful storage cupboard and a dressing area.

Balmoral

1136 sq ft

Lindum Homes gives notice that the property particulars and related information shown in this publication are set as a general outline for guidance only.

Intending purchasers or tenants should not rely on them as statements or representations of fact, but must satisfy themselves by physical inspection of the property in question or otherwise as to their accuracy.

Ground Floor

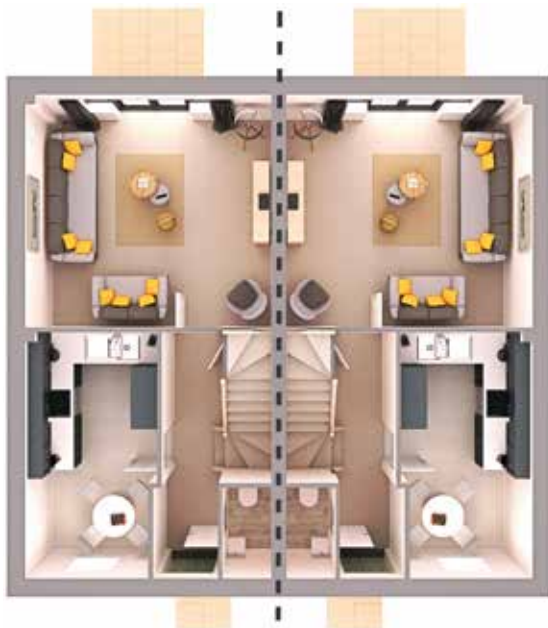

LOUNGE 4739 x 4494mm (15' 7" x 14' 9")

KITCHEN 4745 x 2548mm (15' 7" x 8' 4")

GARAGE 5085 x 2610mm (16' 8" x 8' 7")

First Floor



BED 2 4739 x 2680mm (15' 6" x 8' 9")

BED 3 2771 x 2428mm (9' 1" x 7' 11")

STUDY 2247 x 1754mm (7' 4" x 5' 9")

Second Floor



BED 1 5450 x 3652mm (17' 10" x 12' 0")

All measurements are maximum (Inc Bay windows & Wardrobes) • Sq ft excludes garage space